



# Main Relay

## Replacement

### WARNING

- Do not smoke while working on fuel system. Keep open flame away from work area.
- Block front wheels before jacking up rear of car.

1. Jack up rear of car and place jack stands in proper locations.
2. Remove left rear wheel.
3. Remove the fuel pump cover.
4. Disconnect fuel lines and electrical leads at the fuel pump.
5. Removing three bolts, remove fuel pump with mount.

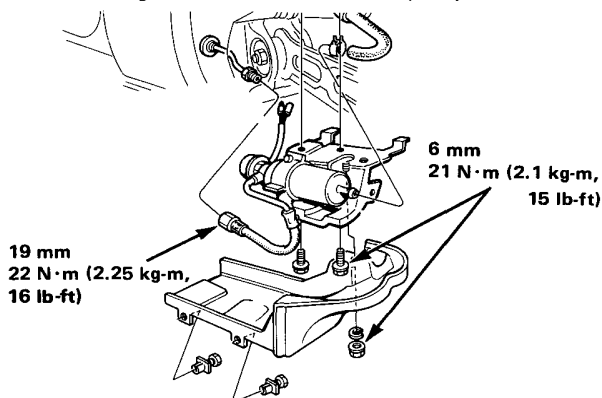

### NOTE:

- When assembling the flare joint part, clean the joint area and coat its screw part with new engine oil. (Assemble the joint soon after engine oil is applied to it.)
- Bring the sealing surfaces into proper contact, tighten the flare nut.
- After the installation work is completed, turn the ignition switch ON. (Do not operate the starter) As the fuel pump is operated for approximately two seconds, the fuel pressure in the fuel line rises. Repeat this operation two to three times, and check whether there is any leakage of fuel in the fuel line.

## Silencer Replacement

1. Remove the fuel line and the silencer from the pump.

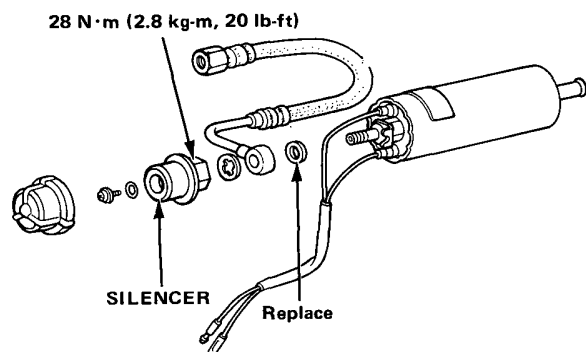

**CAUTION:** Do not disassemble the pump

## Testing

1. Remove the main relay located under the dash.
2. Connect the battery positive terminal to the No. 4 terminal and the battery negative terminal to the No. 8 terminal of the main relay.
3. Check that there is continuity between the No. 5 terminal and the No. 7 terminal of the main relay.
4. Connect the battery positive terminal to the No. 5 terminal and the battery negative terminal to the No. 2 terminal of the main relay.
5. Check that there is continuity between the No. 1 terminal and the No. 3 terminal of the main relay.
6. Connect the battery positive terminal to the No. 3 terminal and the battery negative terminal to the No. 8 terminal of the main relay.
7. Check that there is continuity between the No. 5 terminal and the No. 7 terminal of the main relay.

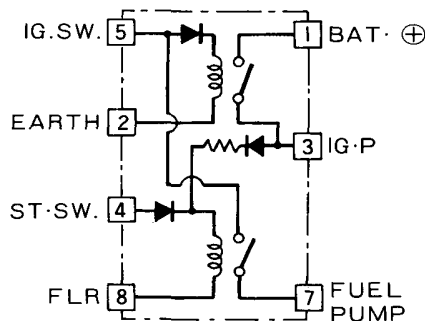
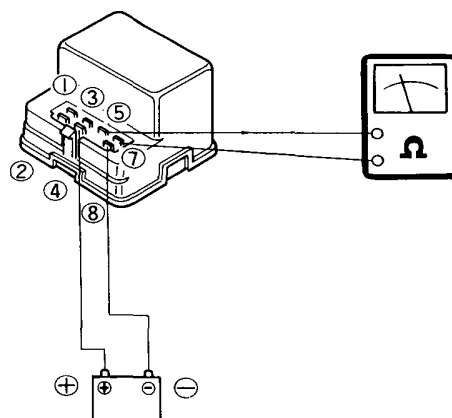

If there is no continuity, replace the main relay.